

## WSFP

Die-cast aluminium reinforced support plate, suitable for WBJ, PTAC, WBM, WBOV mounts. It allows the internal cable to pass through a slot, and the threaded holes at the side, to connect to the WBOV bracket. Epoxypolyester powder painted.

## PTCC

Pole mount adaptor for PTBC bracket. It allows the Pan & Tilt/bracket couple to be firmly attached to the pole. Epoxypolyester powder painted.

## WCW

Corner adaptor for WBJ, PTAC, WBM, WBOV mounts. It allows the internal cable to pass through a slot, and the threaded holes at the side, to connect to the WBOV bracket. Epoxypolyester powder painted.

## WCWGC

Corner adaptor for PTBC bracket. It allows the Pan & Tilt/bracket couple to be firmly attached to the corner. Made of stainless steel, the adapter is epoxypolyester powder painted.

## WCP

Die-cast aluminium reinforcing support plate, suitable for WBJ, PTAC, WBM, WBOV mounts. It allows the internal cable to pass through a slot, and the threaded holes at the side, to connect to the WBOV bracket. Epoxypolyester powder painted.

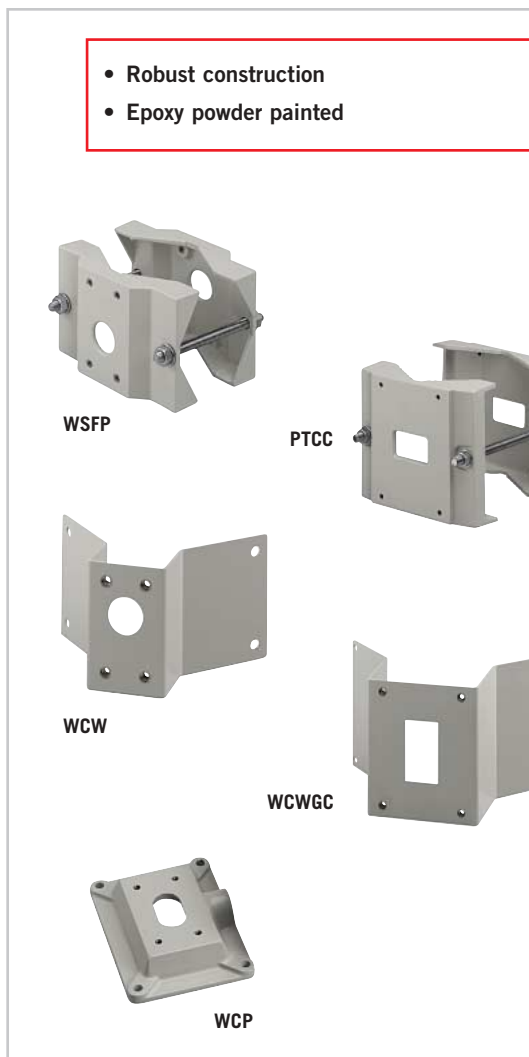

- Robust construction
- Epoxy powder painted

2



BRACKETS

ADAPTORS AND BRACKETS CHART					
	WALL	CORNER		POLE	
	WCP	WCW	WCWGC	WSFP	PTCC
BRACKETS:					
WBJ	•	•		•	
WBM	•	•		•	
WBOV	•	•		•	
PTAC	•	•		•	
PTBC			•		•

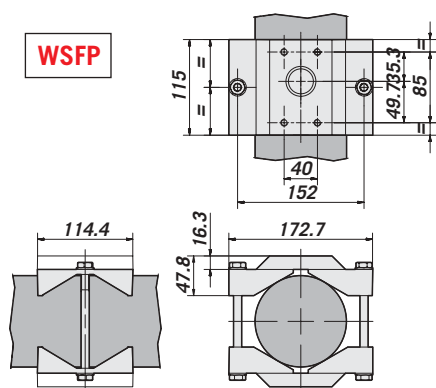
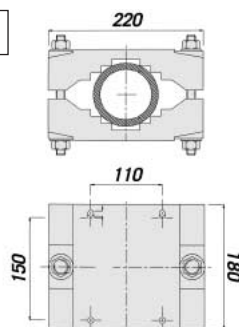
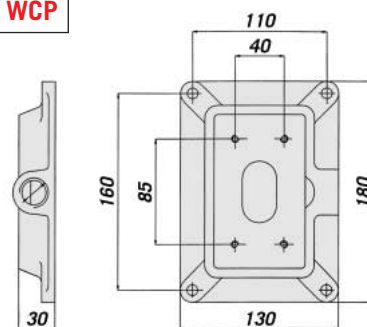
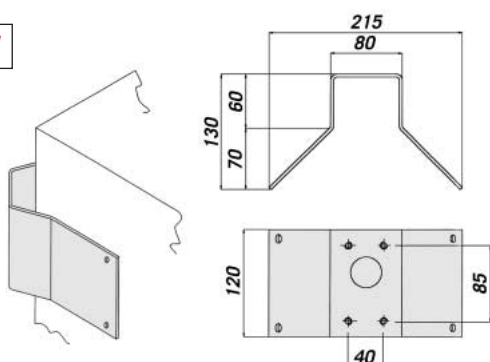
**WSFP****PTCC****WCP****WCW**

The values are in millimeters.

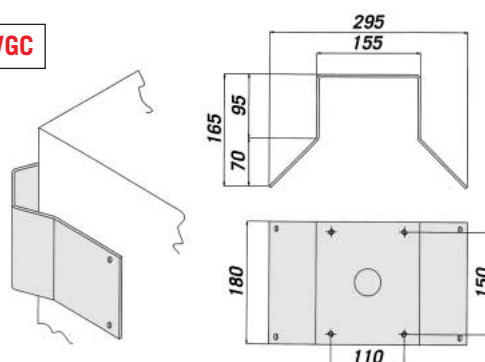
**WCWGC**

## TECHNICAL DATA

## GENERAL

**WSFP**

- Die-cast aluminium
- Epoxypolyester powder painted, colour RAL9002
- Stainless steel screws

**PTCC**

- Die-cast aluminium
- Epoxypolyester powder painted, colour RAL9002
- Stainless steel screws

**WCW**

- Made of steel
- Epoxypolyester powder painted, colour RAL9002

**WCWGC**

- Made of steel
- Epoxypolyester powder painted, colour RAL9002

**WCP**

- Die-cast aluminium
- Epoxypolyester powder painted, colour RAL9002

## MECHANICAL

**WSFP**

- Pole installation
- Load rating 30 kg (66.13 lb)
- Pole: Ø 65 - 110mm (2.55 - 4.33 in)

**PTCC**

- Pole installation
- Load rating 50 kg (11.22 lb)
- Pole: Ø 80 - 150 mm (3.14 - 5.9 in)

**WCW**

- Corner installation
- Load rating 30 kg (66.13 lb)

**WCWGC**

- Corner installation
- Load rating 50 kg (11.22 lb)

**WCP**

- Wall installation
- Load rating 50 kg (11.22 lb)

## ENVIRONMENT

- Indoor/outdoor

**Unit Weight (kg / lb):**

WSFP: 1 / 2.2  
PTCC: 2,6 / 5.7  
WCW: 1 / 2.2  
WCWGC: 2,2 / 4.85  
WCP: 0,6 / 1.32

**Package Weight (kg / lb):**

WSFP: 1 / 2.42  
PTCC: 2,78 / 6.12  
WCW: 1,1 / 2.42  
WCWGC: 2,6 / 5.7  
WCP: 0,7 / 1.54

**Package Dimensions (cm / in):**

WSFP: /  
PTCC: 14x25,5x20 / 5.51x10.03x7.87  
WCW: 14,5x15x26,5 / 5.7x5.9x10.43  
WCWGC: 23,5x31,5x24,5 / 9.25x12.4x9.64  
WCP: 9,5x15,5x23 / 3.74x6.10x9.05

**Master Carton (units):**

WSFP: 30  
PTCC: 15  
WCW: 20  
WCWGC: 6  
WCP: 30