

MS-4Xi



MS-4Xi: At a Glance

- Decodes/second: up to 10
- X-Mode Decoding Technology
- Integrated Ethernet Connectivity
- 10 to 30 VDC



ESP® Easy Setup Program: Single-point software provides quick and easy setup and configuration of all Microscan readers.



EZ Button: This performs reader setup and configuration with no computer required.



Visible Indicators: Include "good read" green flash, LEDs and symbol positioning tool.

For more information on this product, visit www.microscan.com.

MS-4Xi: Available Codes

Linear	All Standard	Postal Codes	
Stacked	MicroPDF	PDF417	GS1 Databar
2D	Data Matrix	QR	Micro QR

Ultra-Compact Ethernet Imager

The MS-4Xi features ultra-compact size and wide angle optics to provide the widest field of view available for reading any symbol at close range. Aggressive decoding is ensured through X-Mode technology, which reads direct part marks and damaged or difficult symbols with no configuration or setup required.

Easy setup and advanced decoding make the MS-4Xi the ideal imager for reliable reading in almost any automation environment.

X-Mode Technology

Our patented X-Mode technology provides easy setup and deployment of the MS-4Xi in any application. In addition to reliable decoding of damaged or difficult linear codes and 2D symbols, the MS-4Xi features advanced decode algorithms to read a wide range of direct part marks.

Compact & Lightweight

The MS-4Xi is the world's smallest high performance imager. Its small form allows flexible positioning in tight spaces. The lightweight and durable magnesium alloy case weighs less than 2 oz.

Mounting Flexibility

The compact size, right angle mirror option, and corner-exit cable of the MS-4Xi conserve cubic space to create the tightest fit possible within instrumentation and equipment.

Embedded Ethernet

Integrated Ethernet TCP/IP is included for industrial connectivity and high speed communication.

Wide Field of View

The MS-4Xi has an extremely wide field of view and reads linear codes or 2D symbols as close as 1" (25 mm).

Application Examples

- Clinical Instruments**
 - Embedded barcode reading
 - Sample tracking and vial reading
- Medical Devices**
 - Dot peen or laser marks on products
- Electronics**
 - Laser markings on printed circuits boards, flex circuits
 - Sub-assembly tracking
- Semiconductors**
 - Laser marks on packages and components

MICROSCAN®

MS-4Xi IMAGER SPECIFICATIONS AND OPTIONS

Front

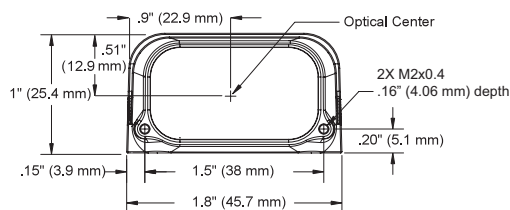

Base

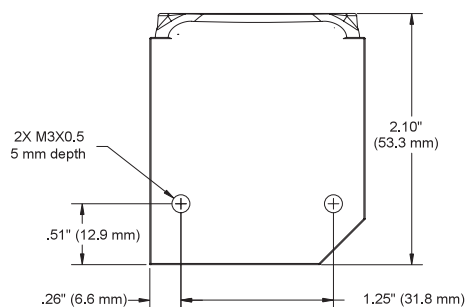

Note: Nominal dimensions shown. Typical tolerances apply.

READ RANGES (GRAPHS AND TABLES)

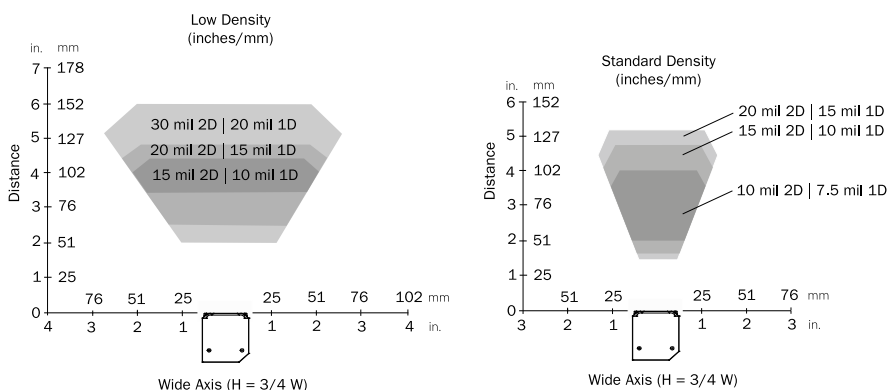

Narrow-bar-width		Field of View (width)*	Read Range
1D	2D	(maximum)	
Standard Density			
.0075" (0.19 mm)	.010" (0.25 mm)	2.4" (61 mm)	2 to 4.0" (51 mm to 102 mm)
.010" (0.25 mm)	.015" (0.38 mm)	2.6" (66 mm)	1.7 to 4.7" (43 mm to 119 mm)
.015" (0.38 mm)	.020" (0.51 mm)	2.8" (71 mm)	1.4 to 5.2" (36 mm to 132 mm)
Low Density			
.010" (0.25 mm)	.015" (0.38 mm)	4.2" (107 mm)	3.5 to 4.5" (89 mm to 114 mm)
.015" (0.38 mm)	.020" (0.51 mm)	4.5" (114 mm)	2.7 to 5.0" (69 mm to 127 mm)
.020" (0.51 mm)	.030" (0.76 mm)	5.5" (140 mm)	2.0 to 6.0" (51 mm to 152 mm)

*Height is 75% of width.
Note: Specifications subject to change.

MECHANICAL

Height: 1" (25.4 mm) **Width:** 1.80" (45.7 mm)
Depth: 2.10" (53.3 mm) **Weight:** 3.2 oz. (91 g)

ENVIRONMENTAL

Enclosure: IP54 (category 2)
Operating Temperature: 0° to 40° C (32° to 104° F)
Storage Temperature: -50° to 75° C (-58° to 167° F)
Humidity: up to 90% (non-condensing)

CE MARK

General Immunity for Light Industry:
EN 55024: 1998 ITE Immunity Standard
Radiated and Conducted Emissions of ITE
Equipment: EN 55022:98 ITE Disturbances

LIGHT SOURCE

Type: High output LEDs



LIGHT COLLECTION OPTIONS

Progressive scan, square pixel.
Software adjustable shutter speed,
electronic shutter
VGA: 640 by 480

SYMBOLGY TYPES

2D Symbolgies: Data Matrix (ECC 0-200),
QR Code, Micro QR Code, Aztec Code
Stacked Symbolgies: PDF417, Micro PDF417,
GS1 Databar (Composite & Stacked)
Linear Barcodes: Code 39, Code 128, BC 412,
I2 of 5, UPC/EAN, Codabar, Code 93,
Pharmacode, PLANET, PostNet, Japanese Post,
Australian Post, Royal Mail, Intelligent Mail, KIX

READ PARAMETERS

Pitch: ±30° **Skew:** ±30° **Tilt:** 360°
Decode Rate: Up to 10 decodes per second

PIN ASSIGNMENTS

M12 12-Pin Plug:

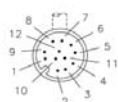

9	Host Rx/D
10	Host Tx/D
2	Power
7	Ground
1	Trigger
8	Input Common
3	Default
4	New Master
5	Output 1
11	Output 2
6	Output 3
12	Output Common

RJ45 Plug:

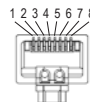

1	TX (+)
2	TX (-)
3	RX (+)
4	NC
5	NC
6	RX (-)
7	NC
8	NC

CONNECTOR

Dual Cable: 6 ft. industrial Ethernet cable with RJ45
plug; and 3 ft. cable with M12 plug

INDICATORS

LEDs: Read Performance, Power, Read Status
Green Flash: Good read
Blue V: Symbol locator
Beeper: Good read, match/mismatch, noread,
serial command confirmation, on/off

COMMUNICATION INTERFACE

Interface: RS-232 and Ethernet

ELECTRICAL

Power: 10-30 VDC, 200 mV p-p max. ripple,
132 mA @ 24 VDC (typ.)

DISCRETE I/O

Trigger Input, New Master: Bi-directional, optoisolated, 4.5-28V rated (10 mA at 28 VDC)
Outputs (1, 2, 3): Bi-directional, optoisolated, 1-28V
rated, (Icc <100 mA at 24 VDC, current limited by user)

SAFETY CERTIFICATIONS DESIGNED FOR

FCC, UL/cUL, CE, CB, Class A

ROHS/WEEE COMPLIANT

ISO CERTIFICATION

Certified ISO 9001:2008 Quality Management System

©2012 Microscan Systems, Inc. SP081A 11/12

Read Range and other performance data is determined using high quality
Grade A symbols per ISO/IEC 15415 and ISO/IEC 15416 in a 25° C
environment. For application-specific Read Range results, testing should be
performed with symbols used in the actual application. Microscan Applica-
tions Engineering is available to assist with evaluations. Results may vary
depending on symbol quality. **Warranty**—One year limited warranty on parts
and labor. Free extended 3 year warranty upon online product registration.

MICROSCAN®

Microscan Systems Inc.

Tel 425 226 5700 / 800 251 7711
Fax 425 226 8250

Microscan Europe

Tel 31 172 423360 / Fax 31 172 423366

Microscan Asia Pacific

Tel 65 6846 1214 / Fax 65 6846 4641

www.microscan.com

Product Information: info@microscan.com
Technical Support: helpdesk@microscan.com