

# AC1200 AMPLIFY

## RE6700 Wi-Fi RANGE EXTENDER

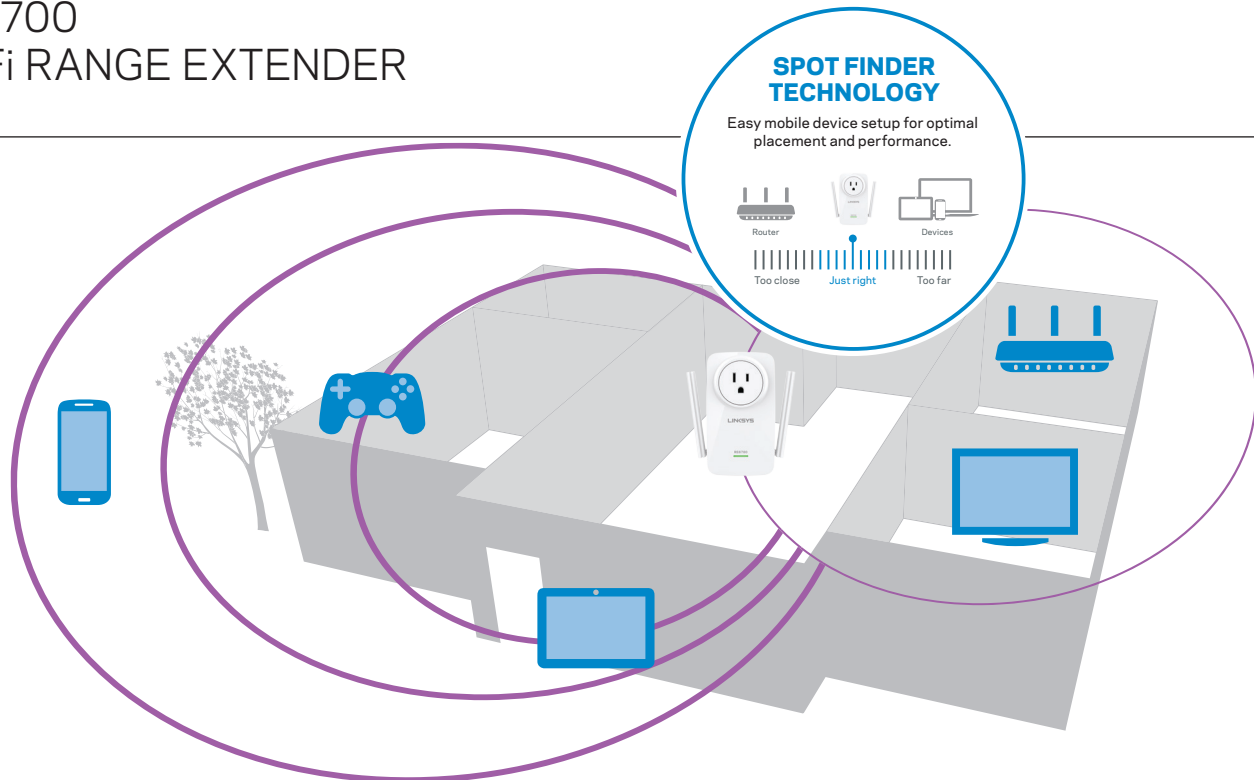

The Linksys AC1200 Amplify Wi-Fi Range Extender (RE6700) works with any Wi-Fi router to expand your wireless coverage area inside and outside your home.\*

Featuring exclusive Spot Finder Technology, the AC1200 Amplify allows users to visually see the best placement spot for the RE6700 from a current router for optimal Wi-Fi range. Spot Finder Technology automatically activates when the setup process is launched. It is a browser-based software that works on any mobile device. Just follow a few prompts for a hassle-free setup and improved Wi-Fi to existing dead zones.

Delivering Wi-Fi speeds your household needs at up to AC1200 (N300 + AC867 Mbps\*), this innovative range extender is engineered with Cross-Band Technology so it can send and receive data on both bands at the same time for uninterrupted streaming and gaming. Beamforming focuses and strengthens the Wi-Fi signal, while the two external antennas amp up performance and throughput. The AC1200 Amplify is compatible with any router without having to modify router settings. Flexible plug-in placement maintains use of an existing wall outlet with leading-edge, pass-through functionality—a new and unique offering for Wireless-AC range extenders. It also comes with one Gigabit port for the fastest possible wired connection, perfect for heavy-bandwidth gaming. And for music lovers, the Wi-Fi audio extender enables you to wirelessly stream music from any mobile device, tablet, or laptop. Simply connect speakers to the range extender to play and control tunes from anywhere in your home.

### Key Features and Benefits

- **Extended Wi-Fi Reach:**  
Wireless-AC coverage in and around your home.
- **Spot Finder Technology:**  
Easy mobile device setup guides optimal placement for superior performance.
- **Integrated Power Outlet:**  
Flexible and discreet placement allows you to maintain use of a wall outlet.
- **Works With Any Router:**  
Works with all Wi-Fi routers, including those from service providers, without having to modify router settings.
- **Dual-Band (5 GHz + 2.4 GHz):**  
Two independent, dedicated Wi-Fi bands that deliver combined speeds of up to 1167Mbps.
- **Cross-Band Technology:**  
Simultaneously transmits and receives data to maximize use of both bands.
- **Beamforming Technology:**  
Focuses Wi-Fi signal to each device on your network.
- **Wi-Fi Audio Extender:**  
Connect speakers and wirelessly stream music from any enabled device, anywhere in your home.
- **External Antennas:**  
Two external antennas for enhanced performance and throughput.
- **Gigabit Port:**  
Blazing-fast wired data transmission speeds 10x faster than Fast Ethernet.

# AC1200 AMPLIFY

## RE6700 Wi-Fi RANGE EXTENDER

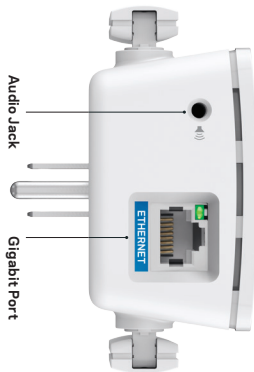

### STREAM MUSIC WIRELESSLY FROM ANYWHERE IN YOUR HOME.

Speakers connect directly to the range extender to enable wireless sound which can be controlled from anywhere in and around your home, using a smartphone, tablet, or laptop.



#### PACKAGE CONTENTS

- Linksys AC1200 AMPLIFY Wi-Fi Range Extender, RE6700
- Quick Installation Guide

#### MINIMUM SYSTEM REQUIREMENTS

- PC or other devices with Ethernet network port
- AC power outlets
- PC/Mac® for utility
- PC: Wi-Fi enabled running Windows® XP SP3, Windows 7, or Windows 8
- Mac: Wi-Fi enabled running Mac OS® X Leopard v10.5.8 or later, Snow Leopard v10.6.1 or later, Lion v10.7, or Mountain Lion v10.8
- Wireless: Existing a/b/g/n wireless router or access point

#### Wireless Operating Spectrum:

Simultaneous Dual-Band  
2.4 GHz and 5 GHz

#### Wireless Security:

Wi-Fi Protected Setup™ button  
WPA®/WPA2® encryption  
SPI firewall  
WEP encryption

#### Ports:

1 Gigabit Ethernet  
3.5 mm audio jack

#### Operating frequency:

2.4GHz: 2412-2472MHz  
5 GHz: 5180-5240 MHz

#### Output Power (EIRP)

2.4GHz:18.89dBm  
5GHz:21.70dBm

#### Antenna Type: Di-Pole

#### Antenna Gain:

2.4GHz: ANT0:3.97dBi, ANT1:3.97dBi  
5GHz: ANT0:5.97dBi, ANT1:5.97dBi

#### Electrical Rating:

AC Input: 220-240V~, 50/60Hz, 13A  
AC Output: 220-240V~, 50/60Hz, 12A Max

Product Weight (kg): 0.27  
Product Depth (cm): 11.91  
Product Width (cm): 8.71  
Product Height (cm): 4.19  
Unit Weight (kg): 0.49  
Unit Depth (cm): 15.18  
Unit Width (cm): 20.29  
Unit Height (cm): 9.19  
Case Pack Quantity (\*PL): 4  
Case Pack Weight (kg) (\*PL): 2.24  
Case Pack Length (cm) (\*PL): 32.51  
Case Pack Width (cm) (\*PL): 20.19  
Case Pack Height (cm) (\*PL): 22.30

Specifications are subject to change without notice.

An active, customer-purchased Internet Service Provider broadband account is required for connection to the Internet.

\*Maximum performance derived from IEEE Standard 802.11 specification. Actual performance can vary, including lower wireless network capacity, data throughput rate, range, and coverage. Performance depends on many factors, conditions, and variables, including distance from the access point, volume of network traffic, building materials and construction, operating system used, mix of wireless products used, interference, and other adverse conditions.

Secure push-button setup works with devices which support Wi-Fi Protected Setup™ such as Linksys Wireless-AC routers and others.



Part Number	Description	UPC	Warranty
RE6700-ME	AC1200 AMPLIFY Wi-Fi RANGE EXTENDER	745883686612 EAN 4260184665600	2-Year Limited Warranty

[linksys.com](http://linksys.com)

© 2015 Belkin International, Inc. and/or its affiliates. All rights reserved.  
Linksys  
Tupolevlaan 1, 1119 NW Schiphol-Rijk, The Netherlands  
Made in Taiwan

Belkin, Linksys, and many product names and logos are trademarks of the Belkin group of companies. Third-party trademarks mentioned are the property of their respective owners. Wi-Fi and Wi-Fi Protected Setup are either trademarks or registered trademarks of the Wi-Fi Alliance. The Wi-Fi CERTIFIED Logo and the Wi-Fi Protected Setup Identifier Mark are either trademarks or registered trademarks of the Wi-Fi Alliance. Mac, Mac OS, and the Mac logo are trademarks of Apple Inc., registered in the U.S. and other countries. Windows is either a registered trademark or trademark of Microsoft Corporation in the United States and/or other countries. 15PB004